

CCASF421-101/ CCASF421-108

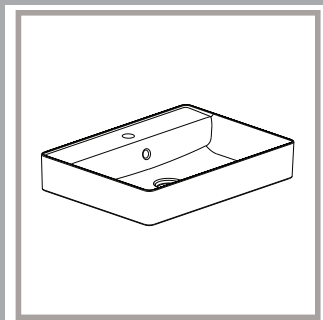

American Standard

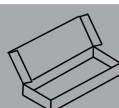
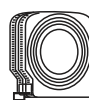
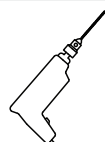
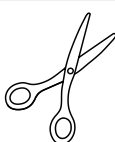
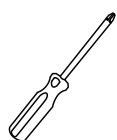
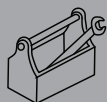
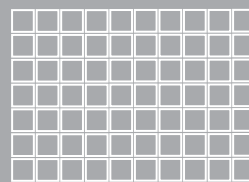

CCASF421-101

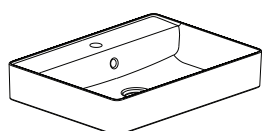

— x1



x1

— x1



x1

— x1

CCASF421-108

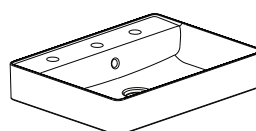

— x1



x1

— x1



x1

— x1

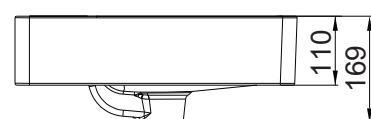
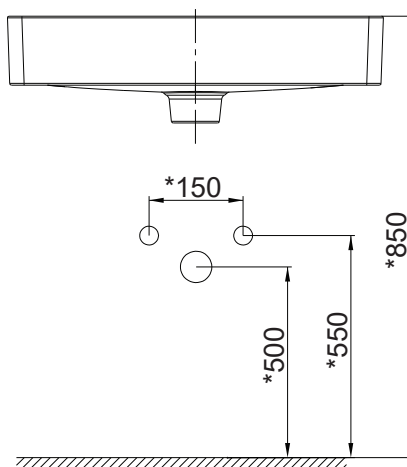
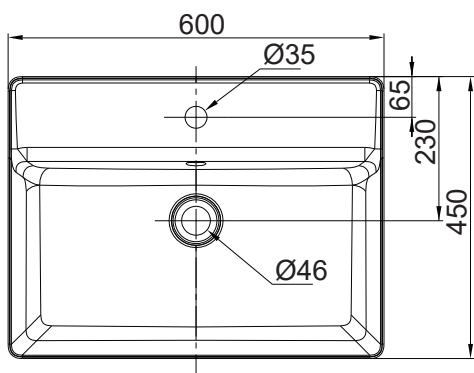

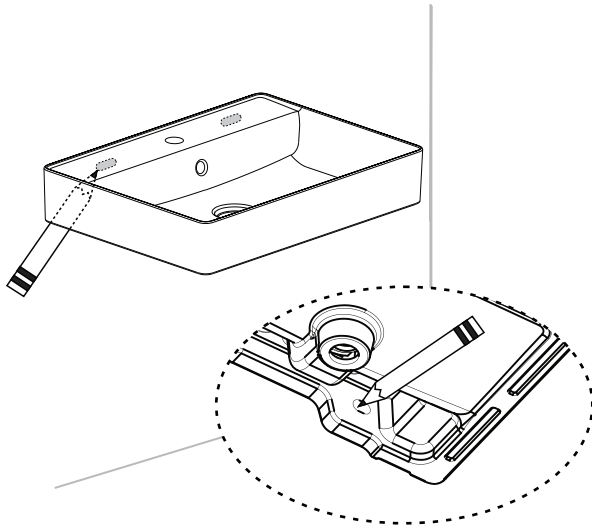

1

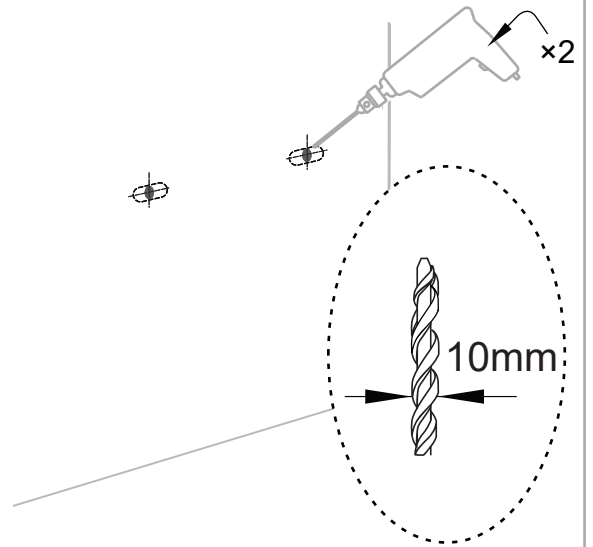

2

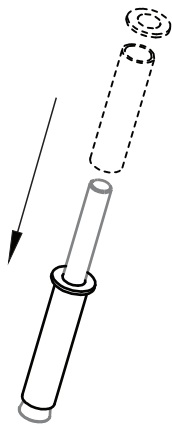

3

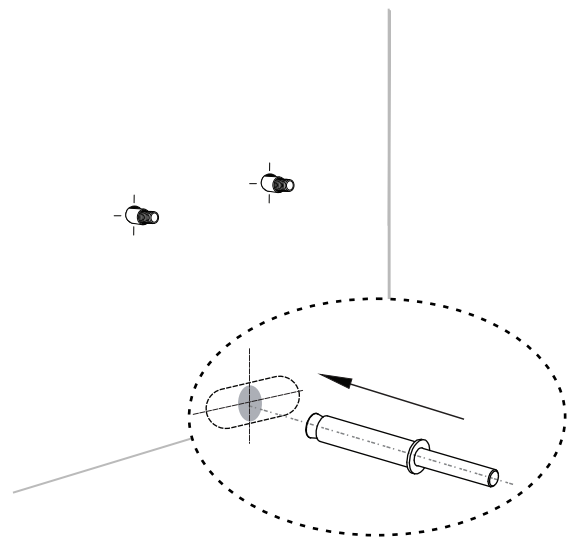

4

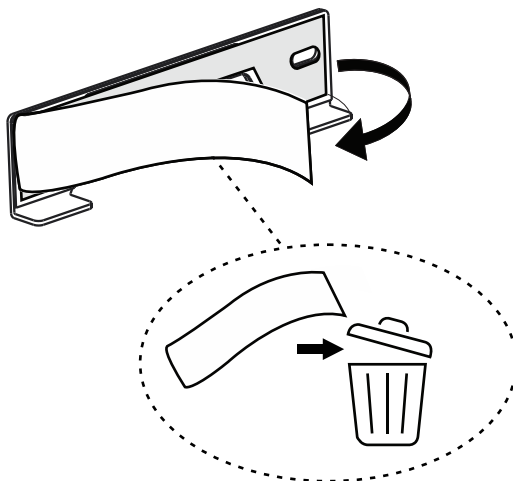

5

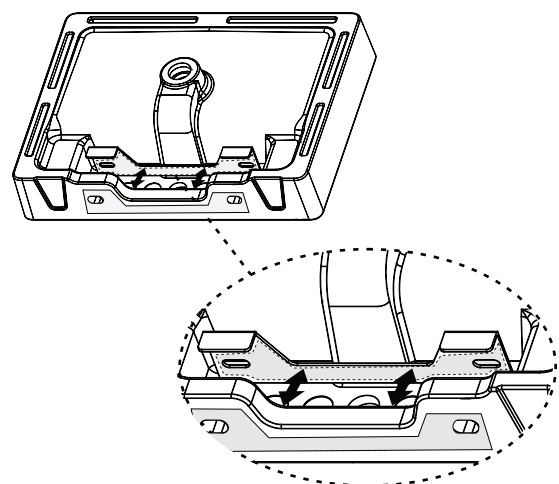

6

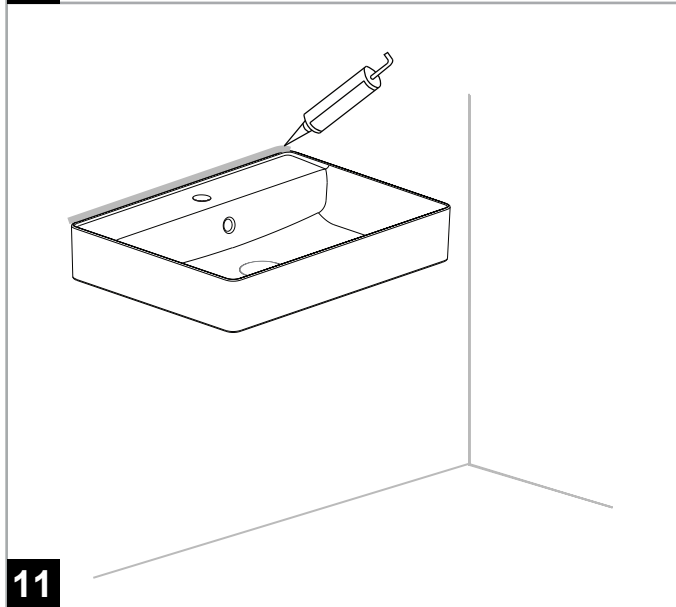
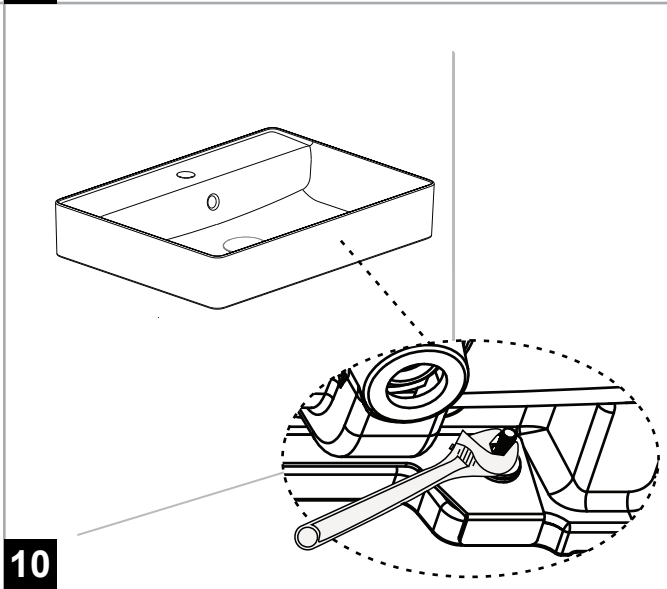
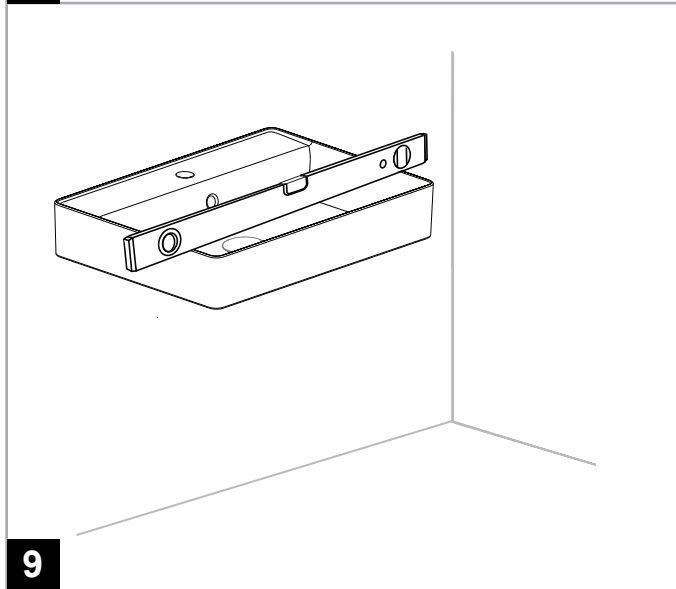
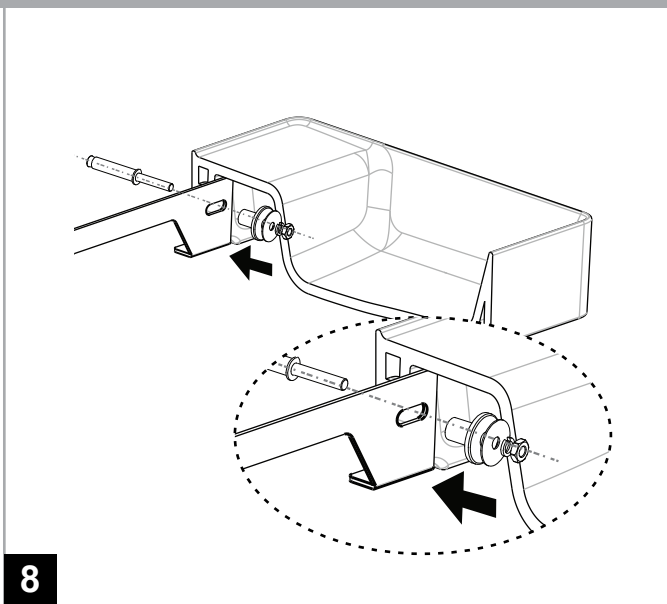
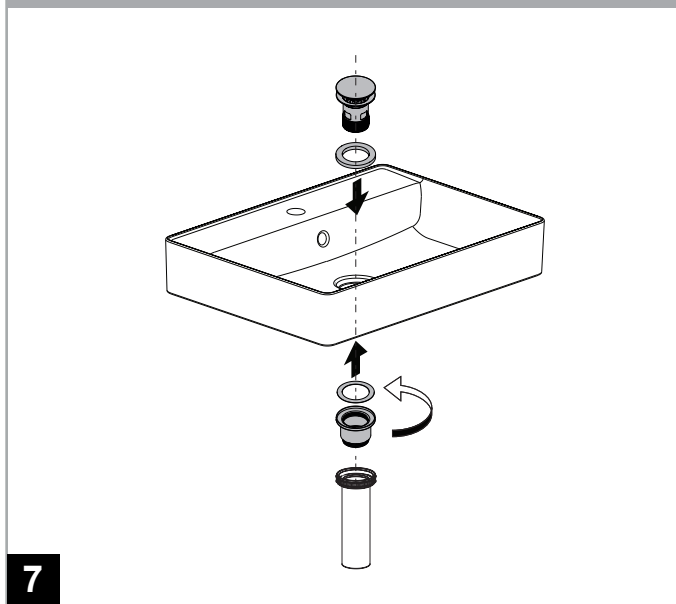

CCASF421-
1010411C0/
CCASF421-
1010411F0

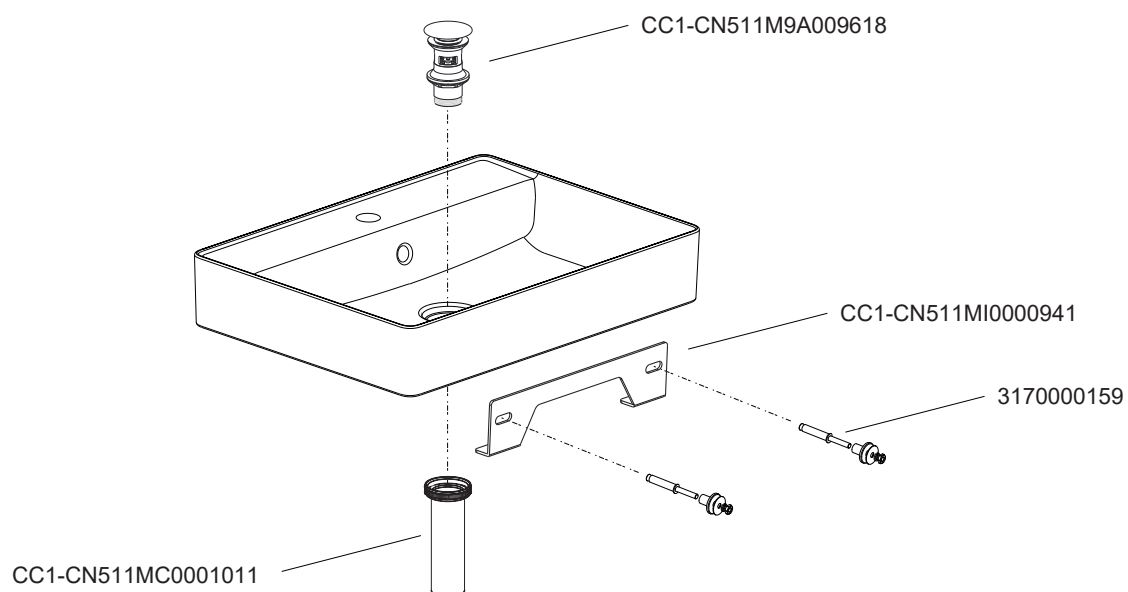

CCASF421-
1080411C0/
CCASF421-
1080411F0

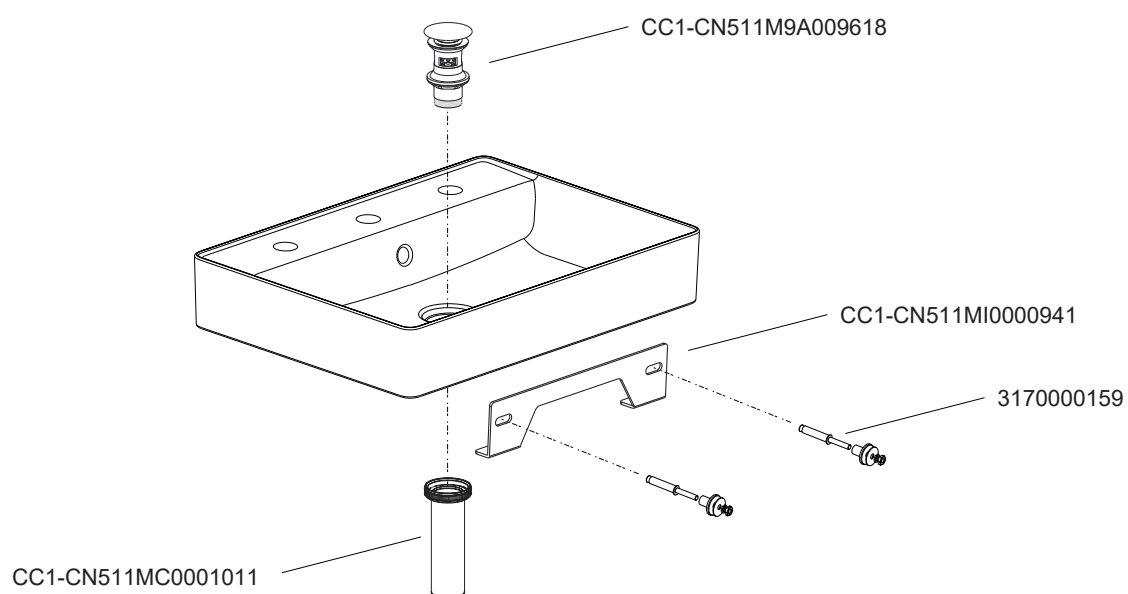

BEFORE YOU BEGIN

- Thank you for selecting our products...products which have been the benchmarks of fine quality for years. To help ensure that the installation process will proceed smoothly, please read these instructions carefully before you begin. Also, review the recommended tools and materials list; carefully unpack and examine your new plumbing fixture.
- ALL INSTALLATION PROCEDURES MUST COMPLY IN STRICT ACCORDANCE WITH APPLICABLE LOCAL PLUMBING AND BUILDING CODE.
- This installation manual is only for installing the ceramic parts. For drainage installation, please refer to relative manual.
- Fragile products.
Be careful to avoid the risk of product break or personal injury.
- Pictures may not exactly define contour of china and components.

NOTES

- Do not use heavy power to hit the product, avoid water leakage of product damage.
- Do not use the product when water temperature is below zero degree centigrade.
- The unit is millimeter by default, if the drawings are not indicate.

CARE AND MAINTENANCE

Do not use harsh abrasives or caustic cleansers to clean fixture surface. A mild detergent, warm water, and a soft cloth will remove normal dirt and soap accumulations from fittings and surfaces. Rinse thoroughly after cleaning and polish with a soft dry cloth to restore original luster of material.

DISCLAIMER

Please carefully check whether you have received the drainage device CC1-CN511M9A009618, which is the designated accessory specially designed for this product. To ensure your use of product, we strongly recommend to install this designated device for the product. American Standard shall not be liable for any quality issues and losses including product damage and water leakage caused by the use of non-designated drainage devices.

安装之前

- 感谢阁下选用我们的产品……我们的产品多年来一直是优良质量的标志。为了有助于安装顺利进行，请您在开始安装之前仔细阅读这些指南，也请查阅推荐的工具和材料表；小心打开您的新产品。
- 所有的安装程序必须严格遵从当地的卫浴和建筑法规条例。
- 此安装说明书只针对陶瓷部分的安装予以简要说明，落水的安装请参见相应的安装说明书。
- 易碎产品。
小心轻放以避免产品破碎和人身伤害。
- 图片可能与实物存在差异，请以实物为准。

注意

- 请不要用重力撞击陶瓷，以防止破损漏水。
- 不要在零摄氏度以下环境中使用。
- 尺寸图未标注单位的统一默认为毫米。

保养和清洁

不要用粗糙的研磨剂和腐蚀性的清洗器清洁产品表面。用温和的清洁剂，温和的水和一张软布就可以将配件和产品表面的一般污渍和肥皂聚积物清除干净。在清洗之后用柔软的干布将产品表面擦干使之恢复原有的光泽。

免责声明

请仔细检查是否已收到专为本产品设计的指定配件——排水装置CC1-CN511M9A009618。为保证产品的正常使用，我们强烈建议您为产品安装该指定排水装置。美标不负责客户因安装非指定排水装置而造成的产品损坏、漏水等问题及相关损失。